

# *City of* BUNKER HILL VILLAGE

## Warrenton and Kilts Reconstruction Project

The City has awarded a contract to AAA Asphalt Paving in the amount of \$2,574,666.50 for the reconstruction of streets, drainage and water lines for Warrenton Drive and Kilts Drive with pavement repairs and water line replacement on portions of Valley Star Drive.

The project is planned to start June 3, 2019 and the contract is for 225 calendar days from the date of commencement.

### Project Contacts

The City's Project Management Consultant is Lloyd, Smitha & Associates, LLC and may be reached through the following contacts:

Ed Lloyd 281-660-8737 Josh 832-814-4158

## PROJECT LOCATION

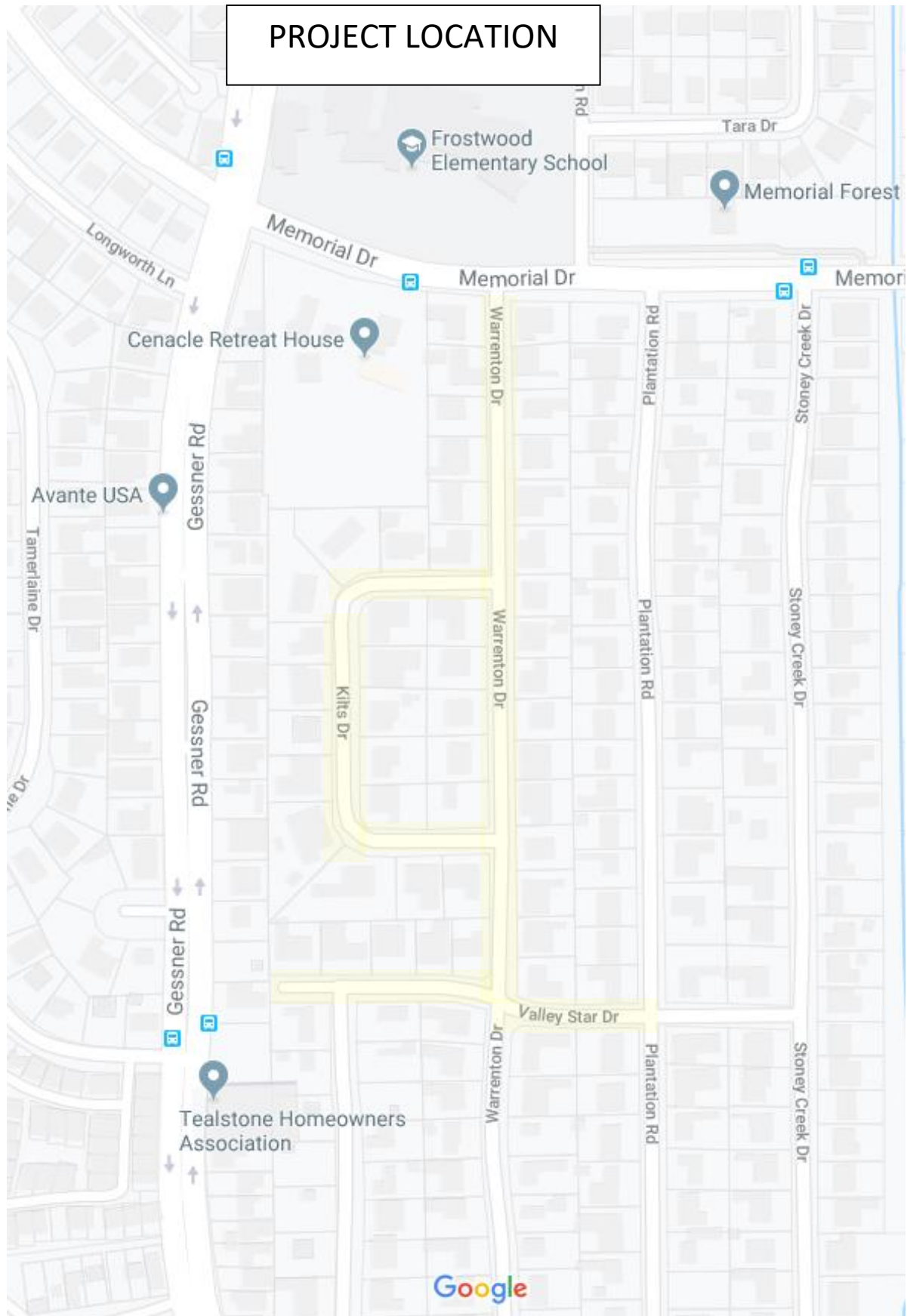

# TREES IMPACTED BY THE PROJECT

Warrenton, Valley Star, Kilts

Tree Survey

City of Bunker Hill Village

Tree No.		Comments	Treatments	Location	Page No.
1	10" Live Oak		Root Prune, Clearance Prune	178 Warrenton	21
2	24" Live Oak	Fair, Trunk scars	Root Prune, Clearance Prune	178 Warrenton	21
3	7" Crape Myrtle		Clearance Prune	182 Warrenton	21
4	3" Crape Myrtle		Clearance Prune	182 Warrenton	21
5	18" Loblolly Pine	Fair, Butt rot	Root Prune	182 Warrenton	21
6	15" Loblolly Pine		Root Prune	182 Warrenton	21
7	16" Loblolly Pine		Root Prune	182 Warrenton	21
8	26" Loblolly Pine		Root Prune	202 Warrenton	21
9	22" Loblolly Pine		Root Prune	202 Warrenton	21
10	22" Loblolly Pine	Fair Condition	Root Prune	202 Warrenton	21
11	13" Loblolly Pine	Fair Condition	Root Prune	202 Warrenton	21
12	No Tree				23
13	4" Live Oak	Base injury	No Issue	209 Warrenton	23
14	20" Loblolly Pine		Root Prune	209 Warrenton	23
15	18" Loblolly Pine	50% cut, New House	Root Prune	209 Warrenton	23
16	24" Loblolly Pine	"V" Crotch	Root Prune	209 Warrenton	23
17	20" Post Oak	50% cut, Leans, Poor	Clearance Prune	209 Warrenton	23
18	28" Loblolly Pine	"V" Crotch, Heart rot	Root Prune	202/210 Warrenton	23
19	12" Loblolly Pine	Not shown on plan	Root Prune	210 Warrenton	23
20	14" Loblolly Pine	Not shown on plan	Root Prune	210 Warrenton	23
21	16" Loblolly Pine	Injuries, Poor	REMOVE	210 Warrenton	23
22	18" Loblolly Pine	Sparse Canopy	REMOVE	210 Warrenton	23
23	17" Loblolly Pine	Suppressed	Re-alignment	214 Warrenton	23
24	29" Loblolly Pine	Light in tree	Re-alignment	214 Warrenton	23
25	25" Willow Oak	Poor Condition	Root Prune	218 Warrenton	23
26	13" Shumard Oak		Root Prune, Clearance Prune	213 Warrenton	25
27	17" Loblolly Pine		Root Prune	213 Warrenton	25
28	4" Crape Myrtle		Clearance Prune	215 Warrenton	25
29	8" Ligustrum Shrub		Clearance Prune	215 Warrenton	25
30	8" Ligustrum Shrub		REMOVE	215 Warrenton	25
31	20" Loblolly Pine		Root Prune	215 Warrenton	25
32	20" Loblolly Pine		Root Prune	215 Warrenton	25
33	4" Japanese Yew	Leans	No Issue	215 Warrenton	25
34	12" Live Oak		REMOVE	215? Warrenton	25
35	5" Yaupon Holly		Clearance Prune	215 Warrenton	25
36	20" Loblolly Pine		Root Prune	215 Warrenton	25
37	16" Live Oak	2 stem	Root Prune, Clearance Prune	215 Warrenton	25
38	24" Loblolly Pine	Large surface roots at mailbox	Root Prune	215 Warrenton	25
39	18" Live Oak	Low branches	Root Prune, Clearance Prune	225 Warrenton	25
40	18" Loblolly Pine		Root Prune	229 Warrenton	25
41	22" Loblolly Pine		Root Prune	229 Warrenton	25
42	24" Loblolly Pine		Root Prune	229 Warrenton	25
43	19" Loblolly Pine	Base scar	Root Prune, Clearance Prune	229 Warrenton	25
44	20" Loblolly Pine	Trunk Cavity, Heart rot, Poor	Root Prune	218 Warrenton	25
45	16" Loblolly Pine		Root Prune, Clearance Prune	222 Warrenton	25
46	25" Loblolly Pine	Base cavity	Root Prune, Clearance Prune	222 Warrenton	25
47	18" Loblolly Pine		Root Prune	226 Warrenton	25
48	26" Loblolly Pine		Root Prune	226 Warrenton	25
49	14" Shumard Oak	Not shown on Plans, CROW	REMOVE	226 Warrenton	25
50	18" Loblolly Pine	Leans	Root Prune	226 Warrenton	25
51	20" Crape Myrtle		Clearance Prune	230 Warrenton	25
52	17" Loblolly Pine		Root Prune	230 Warrenton	25
53	8" Bald Cypress	Can be invasive tree roots	Root Prune	230 Warrenton	25
54	11" Live Oak		Root Prune, Clearance Prune	230 Warrenton	25
55	12" Bald Cypress	Can be invasive tree roots	Root Prune, Clearance Prune	230 Warrenton	25
56	10" Bald Cypress	Can be invasive tree roots	Root Prune, Clearance Prune	230 Warrenton	25
57	6" Shumard Oak	"V" Crotch	Clearance Prune	229 Warrenton	27
58	14" Crape Myrtle		Clearance Prune	229 Warrenton	27
59	24" Loblolly Pine	Trunk scar, "V" Crotch	Root Prune	243 Warrenton	27
60	20" Loblolly Pine	2 stem	Root Prune	243 Warrenton	27
61	15" Live Oak		Root Prune, Clearance Prune	243 Warrenton	27



62	4' Shumard Oak	Not shown on Plans	No Issue	247 Warrenton	27
63	28" Loblolly Pine	Trunk scar, Light in tree	Root Prune	247 Warrenton	27
64	4' Sego Palm		Clearance Prune	232 Warrenton	27
65	4' Sego Palm		Clearance Prune	232 Warrenton	27
66	18" Willow Oak	Light in tree	Root Prune, Clearance Prune	232 Warrenton	27
67	16" Water Oak	Light in tree	Root Prune, Clearance Prune	232 Warrenton	27
68	4' Sego Palm		Clearance Prune	234 Warrenton	27
69	12" Loblolly Pine	Crooked Trunk	Root Prune	234 Warrenton	27
70	13" Shumard Oak	Fair Condition	Root Prune, Clearance Prune	234 Warrenton	27
71	20" Pear		Root Prune, Clearance Prune	234 Warrenton	27
*72	14" Red Maple		REMOVE	238 Warrenton	27
73	15" Shumard Oak		Root Prune, Clearance Prune	238 Warrenton	27
74	17" Loblolly Pine		Root Prune	238 Warrenton	27
*75	12" Live Oak		REMOVE	238 Warrenton	27
76	18" Live Oak		Clearance Prune	247 Warrenton	29
77	16" Water Oak		Root Prune, Clearance Prune	247 Warrenton	29
78	18" Loblolly Pine		Root Prune	249 Warrenton	29
78A	3' Sego Palm		Clearance Prune	249 Warrenton	29
79	24" Live Oak	Not shown on plan	Root Prune, Clearance Prune	249 Warrenton	29
*80	25" Loblolly Pine		REMOVE	249 Warrenton	29
81	22" Willow Oak	New House Constructon	Clearance Prune	251 Warrenton	29
82	14" Willow Oak	Poor Condition		251 Warrenton	29
*83	4" Redbud	Dead, Not on Plan	REMOVE	242 Warrenton	29
84	14" Willow Oak		Root Prune	242 Warrenton	29
85	12" Live Oak		Root Prune, Clearance Prune	242 Warrenton	29
86	20" Loblolly Pine		Root Prune	242 Warrenton	29
87	15" Loblolly Pine		Root Prune	242 Warrenton	29
*88	13" Live Oak		REMOVE	242 Warrenton	29
*89	10" Live Oak	Too much Clearance needed	REMOVE	242 Warrenton	29
90	18" Ligustrum Shrub		No Issue	242 Warrenton	29
91	6" Pear	Poor Condition	No Issue	246 Warrenton	29
92	18" Water Oak	Leans to street	Root Prune, Clearance Prune	246 Warrenton	29
93	26" American Elm		Root Prune, Clearance Prune	246 Warrenton	29
94	14" Water Oak	Not shown on plan	Root Prune	246 Warrenton	29
95	16" Live Oak	Low branches	Root Prune, Clearance Prune	250 Warrenton	29
96	15" Live Oak	Not shown on plan	Root Prune, Clearance Prune	250 Warrenton	29
97	17" Loblolly Pine		Root Prune	253 Warrenton	31
98	17" Loblolly Pine		Root Prune	253 Warrenton	31
99	24" Loblolly Pine		Root Prune	253 Warrenton	31
*100	24" Loblolly Pine	Not shown on plan	REMOVE	253 Warrenton	31
101	22" Water Oak	Heartrot, UP, Not on plan	Clearance Prune	253 Warrenton	31
*102	10" Southern Red Oak	Not shown on plan	REMOVE	253 Warrenton	31
103	6" Crape Myrtle		Clearance Prune	253 Warrenton	31
104	14" Live Oak		Root Prune, Clearance Prune	252 Warrenton	31
105	17" Magnolia	Low branches	Root Prune, Clearance Prune	252 Warrenton	31
106	15' Palm	Trunk degrading		252 Warrenton	31
*107	16" Live Oak		REMOVE	252 Warrenton	31
108	4" Crape Myrtle	Not shown on plan	Clearance Prune	252 Warrenton	31
109	16" Loblolly Pine	Located near bore pit	Root Prune	229 Warrenton/Kilts	33
110	20" Loblolly Pine	Located near bore pit	Root Prune	229 Warrenton/Kilts	33
111	10" Crape Myrtle	Bore	No Issue	229 Warrenton/Kilts	33
112	14" Loblolly Pine	Bore	No Issue	229 Warrenton/Kilts	33
113	12" Loblolly Pine	Bore	No Issue	229 Warrenton/Kilts	33
114	22" Loblolly Pine		Root Prune	229 Warrenton/Kilts	33
115	22" Loblolly Pine		Root Prune	229 Warrenton/Kilts	33
116	14" Wax Myrtle	Multi-stem	Clearance Prune	229 Warrenton/Kilts	33
117	4' Sego Palm		Clearance Prune	230 Kilts	33
118	4' Sego Palm		Clearance Prune	230 Kilts	33
119	18" Water Oak	Light in tree, large girdling root	Root Prune, Clearance Prune	230 Kilts	33
120	16" Loblolly Pine	Light in tree, 2 stem	Root Prune	243 Kilts/Warrenton	33
121	22" Loblolly Pine	2 stem	Root Prune	243 Kilts/Warrenton	33
122	14" Loblolly Pine		Root Prune	243 Kilts/Warrenton	33
123	28" Loblolly Pine	2 stem	Root Prune	243 Kilts/Warrenton	33
124	25" Loblolly Pine		Root Prune	243 Kilts/Warrenton	33

125	10" Yaupon Holly		Clearance Prune	243 Kilts/Warrenton	33
126	18" Loblolly Pine	Sparse Canopy, In decline		243 Kilts/Warrenton	33
*127	18" Red Maple	Heartrot, CROW	REMOVE	243 Kilts/Warrenton	33
128	15" Loblolly Pine		Root Prune	241 Kilts	33
129	26" Loblolly Pine		Root Prune	241 Kilts	33
130	18" Loblolly Pine		Root Prune	241 Kilts	33
131	15" Loblolly Pine		Root Prune	241 Kilts	33
132	15" Water Oak	Not shown on plan	Root Prune, Clearance Prune	230 Kilts	35
133	22" Loblolly Pine	Not shown on plan	Root Prune	230 Kilts	35
134	18" Loblolly Pine	Not shown on plan	Root Prune	230 Kilts	35
135	25" Loblolly Pine	Not shown on plan	Root Prune	230 Kilts	35
136	12" Bald Cypress	Not shown on plan, Roots	No Issue	230 Kilts	35
137	No Tree			226 Kilts	35
138	No Tree			226 Kilts	35
139	7" Live Oak		No Issue	226 Kilts	35
140	5" Magnolia		No Issue	237 Kilts	35
141	20' Live Oak		Root Prune, Clearance Prune	237 Kilts	35
142	17" Laurel Oak		Root Prune	237 Kilts	35
143	17" Water Oak		Root Prune	237 Kilts	35
144	25" Post Oak	Roots sensitive to grade	Root Prune, Clearance Prune	233 Kilts	35
145	15" Water Oak	Poor Condition		233 Kilts	35
146	12" Water Oak	Large burl, base of tree	Root Prune	233 Kilts	35
147	24" Loblolly Pine		Root Prune	231 Kilts	35
*148	13" Water Oak	Poor Condition	REMOVE	231 Kilts	35
149	12" Southern Red Oak		Clearance Prune	231 Kilts	35
150	22" Loblolly Pine	Rec-Re-align	Root Prune	231 Kilts	35
151	20" Water Oak	Rec-Re-align	Root Prune, Clearance Prune	231 Kilts	35
152	18" Loblolly Pine	Rec-Re-align	Root Prune	231 Kilts	35
153	6" Live Oak		Bore	226 Kilts	37
154	16" Live Oak		Root Prune, Clearance Prune	222 Kilts	37
155	16" Live Oak		Root Prune, Clearance Prune	222 Kilts	37
156	7" Crape Myrtle			222 Kilts	37
157	4" Crape Myrtle	Poor Condition		222 Kilts	37
158	12" Water Oak		Clearance Prune	222 Kilts	37
159	8" Water Oak		Clearance Prune	227 Kilts	37
160	6" Water Oak		Clearance Prune	227 Kilts	37
161	5" Water Oak		Clearance Prune	227 Kilts	37
162	24" Loblolly Pine	Leans	Root Prune	227 Kilts	37
163	15" Water Oak		Root Prune, Clearance Prune	223 Kilts?	37
164	12" Water Oak		Root Prune, Clearance Prune	223 Kilts?	37
165	10" Lacebark Elm		Root Prune, Clearance Prune	219 Kilts	37
166	13" Water Oak		Root Prune, Clearance Prune	218 Kilts	39
167	14" Cherrybark Oak		Root Prune, Clearance Prune	218 Kilts	39
*168	22" Laurel Oak	Rec-Realign	REMOVE	214 Kilts	39
*169	24" Water Oak	Poor Condition, CROW	REMOVE	214 Kilts	39
170	18" Willow Oak		Root Prune, Clearance Prune	214 Kilts	39
171	12" Live Oak		No Issue	219 Kilts	39
172	6" Live Oak		No Issue	219 Kilts	39
173	20" Loblolly Pine		Root Prune, Clearance Prune	215 Kilts	39
174	21" Loblolly Pine		Root Prune	211 Kilts	39
175	20" Loblolly Pine		Root Prune	211 Kilts	39
176	30" Loblolly Pine		Root Prune	211 Kilts	39
177	18" Loblolly Pine		Root Prune	207 Kilts	39
178	5" Live Oak	Not shown on plan	No Issue	209 Kilts	41
179	21" Loblolly Pine	Open cut, Not on plan	Root Prune	209 Kilts	41
180	22" Loblolly Pine	Leans, hazard, mounding	Private tree	209 Kilts	41
181	11" Gum Bumelia		Clearance Prune	209 Kilts	41
182	6" Gum Bumelia		Clearance Prune	209 Kilts	41
183	24" Loblolly Pine		Root Prune	209 Kilts	41
184	20" Loblolly Pine	Not shown on plan	Root Prune	207 Kilts	41
185	15" Ligustrum Shrub		Clearance Prune	207 Kilts	41
186	6" Red Maple		Clearance Prune	203 Kilts	41
187	24" Loblolly Pine		Root Prune	203 Kilts	41
188	18" Loblolly Pine	Poor Condition, top out, heartrot	Root Prune	203 Kilts	41

189	14" Cherrybark Oak	Leans, Trunk scar	Root Prune, Clearance Prune	203 Kilts	41
190	18" Loblolly Pine		Bore	12230 Valley Star	43
191	18" Loblolly Pine		Bore	12230 Valley Star	43
192	4" Crape Myrtle		Bore	12222 Valley Star	43
193	4" Crape Myrtle		Bore	12222 Valley Star	43
194	26" Live Oak	Near new Inlet	Root Prune, Clearance Prune	12222 Valley Star	43
195	16" Live Oak	Near water meter	Root Prune, Clearance Prune	12222 Valley Star	43
196	8" Loblolly Pine		Clearance Prune	12218 Valley Star	43
197	5" Loblolly Pine		Clearance Prune	12218 Valley Star	43
198	13" Loblolly Pine		Clearance Prune	12218 Valley Star	43
199	25" Live Oak	Near proposed inlet, Not on plan	Root Prune, Clearance Prune	174 Haversham	43
200	18" Water Oak	No pit located here	Clearance Prune	12218 Valley Star	44
201	19" Water Oak	No pit located here	Clearance Prune	12218 Valley Star	44
202	16" Loblolly Pine		Bore	12214 Valley Star	44
203	12" Loblolly Pine		Bore	12214 Valley Star	44
204	16" Live Oak		Clearance Prune, Bore	12214 Valley Star	44
205	14" Live Oak		Clearance Prune, Bore	12214 Valley Star	44
206	Water Oak	Poor, Borers, Rot at base, Leans		12210 Valley Star	44
207	12" Live Oak	Near pit location	Root Prune, Clearance Prune	178 Warrenton	44
208	21" Live Oak	Near pit location	Root Prune, Clearance Prune	178 Warrenton	45
209	17" Shumard Oak		Bore	203 Plantation	45
210	21" Water Oak		Clearance Prune	203 Plantation	45
211	13" Water Oak		Clearance Prune	203 Plantation	45
212	24" Water Oak	Not shown on plan, Base injury	Root Prune, Clearance Prune	203 Plantation	45
213	12" Post Oak	Ball Moss, base scar	Root Prune, Clearance Prune	203 Plantation	46
214	12" Magnolia		Bore	202 Plantation	46
215	4" Shumard		Bore	202 Plantation	46
216	16" Water Oak		Bore	202 Plantation	46
217	18" Water Oak		Bore	202 Plantation	46
218	13" Loblolly Pine	Not on plan	Clearance Prune	203 Stoney Creek	46
219	24" Water Oak	Poor, Borers, Rot		203 Stoney Creek	46
220	22" Post Oak		Root Prune, Clearance Prune	203 Stoney Creek	46
221	21" Post Oak	Located near bore pit	Root Prune, Clearance Prune	203 Stoney Creek	46



The City's tree supplier has made the following trees available to residents after the project is complete. All trees would be at the resident's expense and must be planted on private property and not in the city's ROW.

**HORTICULTURAL SERVICES, INC.**

**11 Shiloh Arbor Dr.  
Tomball, TX 77377  
281-414-0552**

**Estimate**

Date	Estimate #
5/20/2019	7797

Name / Address
City of Bunker Hill Attn: Steve

		P.O. No.	Project
Description	Qty	Rate	Total
Tree, 45 gal w/ Stakes, Mulch, 1 - Bubbler = \$750 per tree		675.00 75.00	675.00 75.00
Tree, 65 gal w/ Stakes, Mulch, 1 - Bubbler = \$950 per tree		875.00 75.00	875.00 75.00
Contact Mike Capstick at 281-414-0552 with any questions.		<b>Total</b>	

# PROPOSED STREET LIGHT PLAN

Please print all entries below except for signature

Approved and accepted this \_\_\_\_\_ day of \_\_\_\_\_, 2019

Signature: \_\_\_\_\_

Name: \_\_\_\_\_

Title: \_\_\_\_\_

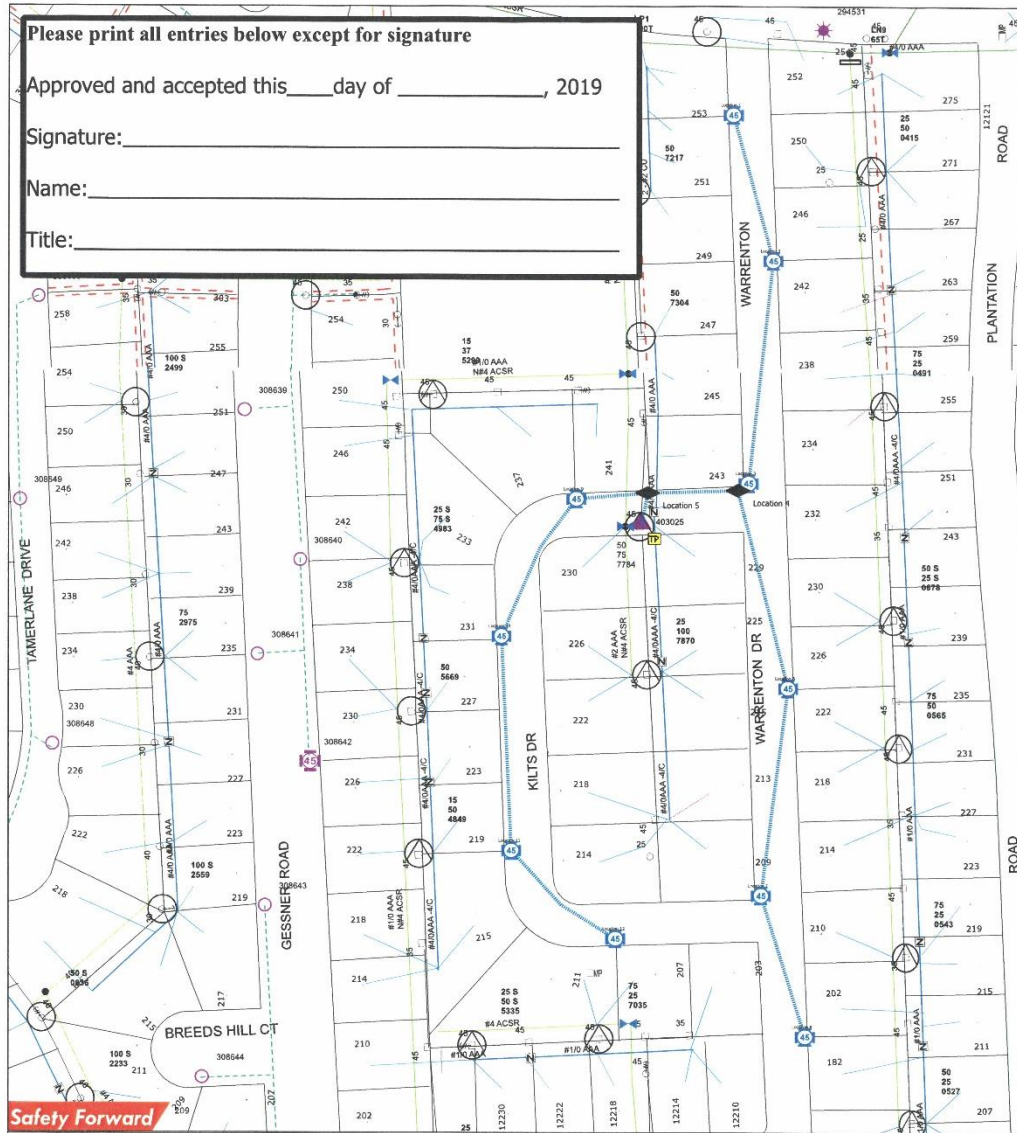

Safety Forward

## LIGHTING DESIGN SERVICES - LIGHTING LEGEND

IMPORTANT NOTE: READ SPECIAL INSTRUCTIONS BELOW AND REFERENCE ANY SPECIAL NEEDS THAT MAY BE SHOWN ON SKETCH.

NEW STREET LIGHT INSTALLATION SYMBOLS										ADDITIONAL INSTALLATION MATERIAL SYMBOLS									
SYMBOL		QUANTITY		SINGLE LAMP WATTAGE AND TYPE (Circle One Lamp Type for Each Wattage)				SYMBOL		QUANTITY		DUAL UG ONLY LAMP WATTAGE AND TYPE (Circle One Lamp Type for Each Wattage)							
		0		100W HPS MH						0		150W HPS MH							
		0		175W HPS MH						0		250W HPS MH							
		0		400W HPS MH						0		45W 95W 115W 180W LED							
		0		45W 95W 115W 180W LED						0		12KV 35KV PROPOSED OVERHEAD TRANSFORMER							
EXISTING STREET LIGHT SYMBOLS AND WATTAGES										2.280 (FEET) UNDERGROUND CONDUCTOR (Check One)									
										Direct Embedded Wire <input checked="" type="checkbox"/>									
										Conduit and Wire									
										OVERHEAD CONDUCTOR									
										#4 2/C TWIST (UNLESS OTHERWISE NOTED)									
INSTALLATION VOLTAGE: (Circle One Only) <input checked="" type="radio"/> 120 <input type="radio"/> 240 <input type="radio"/> 480										Street Light Notes									
STREET LIGHT PLACEMENT DETAIL										-All streets must be curbed and guttered prior to the installation of street lighting facilities unless otherwise approved by the Lighting Design Service Department.									
STREET LIGHT STANDARDS WILL NORMALLY BE INSTALLED IN ROAD RIGHT OF WAY 3' BACK OF CURB AND IN ALIGNMENT WITH SIDE LOT OR REAR PROPERTY LINES, UNLESS THERE IS A CONFLICT WITH DRIVEWAY, FIRE HYDRANT, CATCH BASIN, WATERMETER, OTHER OBSTRUCTIONS, OR WHEN IES RECOMMENDS SPACING REQUIRE OTHERWISE. IN CASE OF CONFLICT WITH 6" H.DISTRIBUTION AT HEAD OF PROPERTY, STANDARD IS TO BE INSTALLED 8" NORTH OR WEST OF PROPERTY LINE.										-Dedicated street light easements are required along all placement of street lighting facilities when such facilities are installed along private streets. Street lighting will only be installed along private streets that can be accessed for maintenance and only when such a street is constructed in an easement intended to contain a private street, waterlines, sanitary sewer lines, storm sewer, and such other utility or franchise infrastructures as can be accommodated and which, for the purpose of established setback, will be considered to be the equal of a public street.									
AT STREET INTERSECTIONS, STANDARDS ARE TO BE INSTALLED BEHIND STRAIGHT SECTION OF CURB 2' FROM TANGENT POINT. STANDARDS SHALL BE PLACED ON STREET SIDE OPPOSITE FROM NORMAL STOP SIGN LOCATIONS.										-The design of all streets, utility easements, and storm sewer easements must be agreed by all appropriate reviewing agencies before the installation of street lighting.									
										-Street lighting will be installed to the recommendations of the Illuminating Engineering Society unless otherwise requested and agreed upon in writing by the requestor of street lighting service.									

NORTH

W.O.#: 89813683 TYPE: HLC1  
 LAMBERT #: 4957-D2KEY MAP: 490/  
 WO BY: SANTOS CALDERON  
 PHONE: 713-945-3234 CELL: 832-727-3841  
 Service Center: Streetlights  
 DATE: 4-15-2019 SCALE: 1"= 60'